

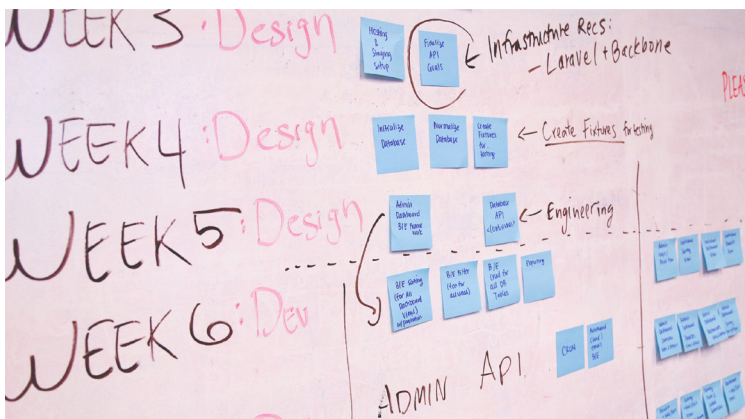

General Project Management

DELIVERING RESULTS

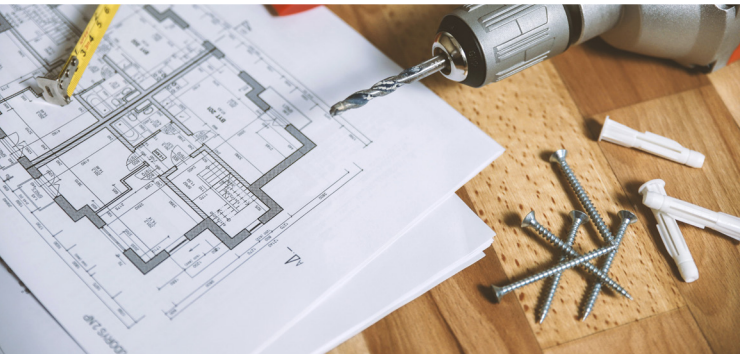



Delivering results

Allworld has been assisting owners and clients since 2010 in successfully administering projects on time and on budget. We combine a wealth of experienced partners to assist with construction and inspection services tailored specifically to our clients and the needs of their projects.

Our strategic partnerships include experienced construction professionals, engineers, and architects with an average of over 20 years of experience in the industry.



Core Services



Project Management



Asset Management



Construction Inspection



Contract and Grant Management



Budget Management



Diversity Inclusion + Programming



Stakeholder and Community Engagement



Right of Way

Industries Served

- State / Federal Government Agencies
- Local Municipalities
- Architectural, Engineering and Industrial Technical Firms
- Construction and Development Companies
- Sustainability and Green Tech Businesses

Examples of Project Profiles

- Big River Crossing | Main to Main
- Shelby Farms Patriot Lake Expansion
- Tiger Lane
- Tom Lee Park
- Shelby County Schools
- Right of Way
- Memphis LED Lighting



Big River Crossing Main to Main Multimodal Connector

LOCATION: Memphis, TN + West Memphis, AR

CLIENT: City of Memphis

PROJECT VALUE: \$40 Million



PROJECT DESCRIPTION

At nearly a mile in length, Big River Crossing is the country's longest active bike-pedestrian rail bridge and the longest public pedestrian bridge across the Mississippi River. The 40 million dollar project serves a 10-mile multi-modal corridor using the historic Harahan Bridge as a restored landmark between Memphis, TN, and West Memphis, AR.

OUR ROLE

AWPM provided program management, construction administration, inspection coordination, and contract/grant management services for the M2M Project. The project resulted in a multi-use, ADA-compliant path from Main Street Memphis, TN, to Main Street West Memphis, AR, across the Harahan Bridge. AWPM provided additional personnel to review bids, facilitate proposal meetings, resolve disputes, and make recommendations to the contracting authority. Main-to-Main was completed two weeks ahead of schedule and four percent under budget.

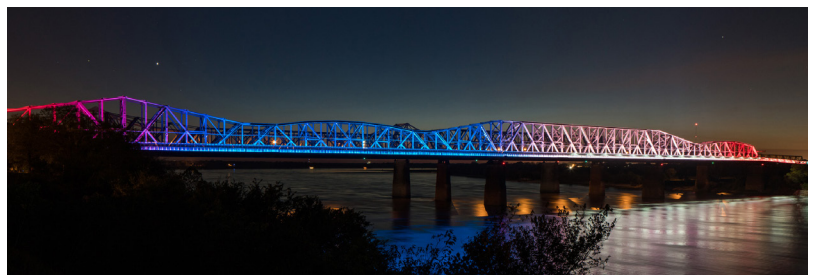



Shelby Farms Park Patriot Lake Expansion

LOCATION: Memphis, TN

CLIENT: Shelby Farms Park

PROJECT VALUE: \$30 Million



PROJECT DESCRIPTION

Shelby Farms Park underwent a \$30 million renovation. The centerpiece of the renovation is the expansion of Patriot Lake, a recreational body of water and main summer attraction for the park. The Patriot Lake expansion to Shelby Farms aided the park in meeting conservation goals through the creation of a serene public landscape.

OUR ROLE

Allworld contributed to this expansion by providing construction administration and diversity programming services. Partnered with General Contractor Montgomery Martin and Shelby Farms administration, Allworld provided on-site staff to alleviate document control responsibilities, provide field oversight and observations, and coordinate diversity inclusion with subcontractors.





Tiger Lane

LOCATION: Memphis, TN

CLIENT: City of Memphis

PROJECT VALUE: \$16 Million



PROJECT DESCRIPTION

Tiger Lane at the Liberty Bowl included creating a centerpiece entrance and green spaces for tailgating during the football season for the University of Memphis Tigers football team.

OUR ROLE

Allworld's inaugural project was the uniquely challenging Tiger Lane tailgating park at the Liberty Bowl in Memphis. AWPM provided construction administration and record-breaking diversity programming for the 16 million dollar project.





Tom Lee Park Renovations

LOCATION: Memphis, TN

CLIENT: Memphis River Parks Partnership

PROJECT VALUE: \$60 Million



PROJECT DESCRIPTION

Tom Lee Park's redesign covers 30 acres of landscaping and various architectural elements, with a project budget of \$60 million. The overall park design was heavily influenced by the Mississippi River's flow patterns, creating opportunities and a sense of motion to smoothly navigate people's movements throughout the park. The new park design is divided into 4 major zones: the Civic Gateway, the Active Core, the Community Batture, and the Habitat Terraces.

OUR ROLE

Serving as owner's rep for the Partnership (Memphis River Parks Partnership), AWPM is responsible for managing the design and construction process, which includes monitoring and tracking the schedule, scope, and budget on behalf of the owner. AWPM hosts and organizes biweekly OAC meetings, attends committee meetings, and provides weekly project status updates to the Partnership.

Additional activities for the project managers included; design confirmation, utility coordination, construction site monitoring and inspection, stakeholder engagement, progress meeting facilitation, and document control. Allworld coordinated a safe, temporary entry for all attendees, including those requiring ADA-compliant access. With a tight schedule, Allworld's constant onsite monitoring leads to quick resolutions and timely delivery of the attraction.





Shelby County Schools

LOCATION: Memphis, TN

CLIENT: Shelby County Board of Education

PROJECT VALUE: \$90 Million+

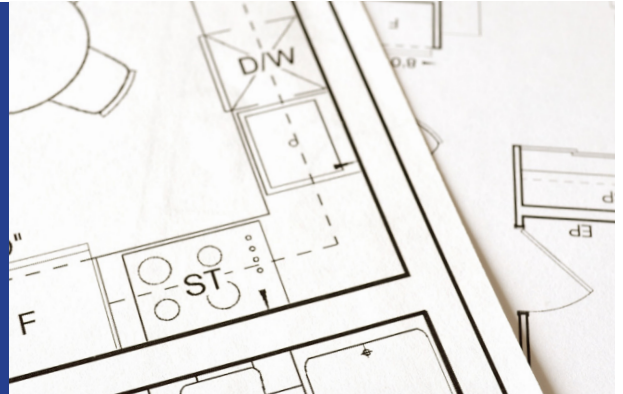

PROJECT DESCRIPTION

In response to a competitive solicitation, in partnership with CBRE | Heery, Allworld Project Management was selected by Shelby County Schools in August 2018 to provide project/program management services. Shelby County Schools (SCS) receives annual funding from the County Commissioners for capital projects and deferred maintenance needs. Funding received for the previous three years (Fiscal Year 2018 and earlier) was used for various projects. The first assignment was to complete and close out 29 ongoing projects for roofing, HVAC window replacements, several additional projects, and a new school already under construction. Quality control inspections were conducted, schedules for completion were developed, and the projects were brought to closeout within two months.

OUR ROLE

Working as an extension of the SCS staff, the project team soon found that the program needed procedures, guidelines, and educational specifications. Work began to develop a series of standard forms, operating procedures, and other tools. A SharePoint site was created to accomplish this general office organization, and all files were converted to digital format. A series of standard reports were developed, and other tools to track and store project data were implemented. The team also served as the district's project manager for the renovation of a former Bayer Pharmaceutical facility that SCS purchased to be used for various administrative departments and functions.

FY19 included 47 projects totaling over \$86M including two new schools, 10 addition/renovation projects, and 35 deferred maintenance projects. Allworld was in charge of site monitoring and inspection, stakeholder engagement, progress meeting facilitation, and document control. Allworld coordinated a safe, temporary entry for all attendees, including those requiring ADA-compliant access. With a tight schedule, Allworld's constant on site monitoring lead to quick resolutions and a timely delivery of the project.



Right of Way

LOCATION: Memphis, TN

CLIENT: City of Memphis



PROJECT DESCRIPTION

Allworld has acted as the Local Participating Agency (LPA) for various projects in accordance with the Uniform Act. Projects included the Nike access road dedication, FedEx pedestrian bridge, Burlington Northern Santa Fe (BNSF) intermodal expansion, Valero pipeline expansion, and various pedestrian signal easements in and around the University of Memphis.

OUR ROLE

AWP acquired property rights on real estate property, negotiated and constructed leases for city-owned property, and facilitated contracts and closings. AWP cataloged over 4,000 tax parcels acquired by the City of Memphis through tax sales and facilitated street and alley closures and any projects requested by other City agencies.





Memphis LED Lighting

LOCATION: Memphis, TN

CLIENT: City of Memphis



PROJECT DESCRIPTION

The City of Memphis sought to convert streetlights from high-pressure sodium (HPS) luminaires of various wattages and styles to light-emitting diode (LED) luminaires of equivalent wattage. The City desired to plan and prepare a request for proposal (RFQ) to solicit qualified contractors to provide “turnkey” products and services, resulting in the successful conversion of the designated streetlights. Specifically, the project consists of the programming, design, and implementation for converting street lighting in the City, estimated at approximately 77,300 units, to equivalent LED street luminaires.

OUR ROLE

Allworld Project Management was hired as the project manager for this ambitious project. Team members Erik Henneghan, lead program manager, and Michael Hooks Jr., principal in charge, worked collectively on the daily responsibility for initiating and executing a plan for procuring and managing a qualified contractor that will replace the City of Memphis’s and MLGW’s (Owner) current lighting system with a more energy efficient and operationally effective LED lighting system.

